

# Osaka Research Institute of Industrial Science and Technology

## Support entrepreneurs who are motivated to develop new products from the technical side

### ■ Incubation facility to accelerate R & D

Osaka Research Institute of Industrial Science and Technology provides a research and development space (open laboratory: It is located on site) for individuals or companies (groups) who start research and development and product development with the aim of starting a new business. When moving in, we will consider what kind of support is possible and schedule a plan until the end of development in collaboration with our researchers. In addition, technical consultation is possible in a timely manner even for sudden issues. That is because there are researchers from various fields.

In addition, since Small and Medium Enterprise Management Consultant visits us on a regular basis, we also accept consultations on management at any time. If you move into the following laboratories, our researchers will support your companionship and development according to the development theme.

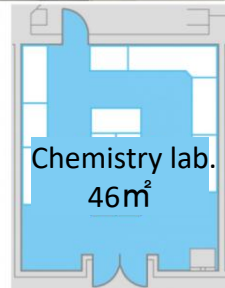
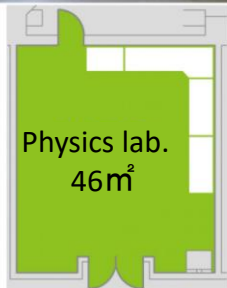

### ■ Main activities and case studies

#### • Technical Consultation

We are staffed with specialists in a wide range of technical fields, and we receive consultations from companies by visiting the institute, telephone, FAX, and E-mail.

#### • Testing

We perform various tests, analysis, and processing of materials and parts upon request from companies.

#### • Facilities Services

Facilities and equipment are generally available for use. Small and Medium-sized Enterprises (SMEs) can also utilize open laboratories for development of new technologies and products.

#### • Commissioned Research

ORIST undertakes researches requested from SMEs under commission.

#### • Technical Training

We accept trainees who wish to acquire specific technological knowledge, research know-how and the skills of operating the latest equipment

■ Providing technical seeds and supporting practical application  
Many companies are doing business using the technology of our laboratory.  
Please feel free to contact us.

Osaka Research Institute of Industrial Science and Technology	
Person in charge	H.Takeda (Mr.)
E-mail	takeda@tri-Osaka.jp
TEL	+81 -(0)725-51-2608
URL	<a href="https://orist.jp/en/">https://orist.jp/en/</a>